

## BEFORE OPERATING:

The Aurand cleaning tool (electric model) is equipped with a universal type motor which is equally efficient on either direct or alternating current. It is furnished for use with either 115 or 230 voltage, **Both voltages are NOT possible on one machine.** The voltage for your machines is stamped on the name plate.

The K tool has been thoroughly tested and shipped complete, but **DO NOT** attempt to operate without reading the following instructions.

## OPERATING INSTRUCTIONS:

1. Wear safety glasses and hearing protection.
2. Grasp both handles and raise front of tool from surface.
3. Squeeze trigger and allow cutters to come up to speed before applying to surface.
4. Using both hands, guide tool in a forward and backward motion to assure complete coverage. Let weight of tool do the work. Never apply pressure as this will slow down motor speed and cause damage to motor, gears, and cutter bundles.

## DEPTH ADJUSTMENT:

When adjustment is required to compensate for cutter wear:

1. Loosen SCREW (Ref 7M)
2. Move DEPTH SHOE (Ref 611) up or down as required. (Cutters should have play in them when touching work surface)
3. Tighten SCREW (Ref 7m)

## CUTTER BUNDLE REPLACEMENT:

1. Install COTTER PIN & WASHER (Ref 76M) on both ends of SPINDLE (Ref 643 or 643E). Cutter tips must point in direction of rotation.
2. Slide CUTTER BUNDLE (Ref 674) and CUTTER BUNDLE FELT (Ref 645) from SPINDLE.
3. Slide new CUTTER BUNDLE FELT & CUTTER BUNDLES on SPINDLE, with large round hole facing side plate. CUTTER TIPS must point in direction of rotation.
4. Install COTTER PINS & WASHER on both ends of SPINDLE.

## LUBRICATION:

Check grease (676) in Gear Housing after every 9 hours of operation . Remove KNOB (Ref 608). With tool sitting level add 676 GREASE through hole. Then replace SCREW & PLUG.

## Aurand Manufacturing & Equipment Company

1210 Ellis St  
Cincinnati OH 45223-1843

800-860-2872 or 513-541-7200  
Fax 513-541-3065

[www.aurand.net](http://www.aurand.net)

We gladly accept:



# AURAND



## K7-1, K7-2 K7-1E, K7-2E

## Parts List & Operating Instructions

# AURAND

**Aurand has manufactured exclusively in the USA since 1937.**

# AURAND

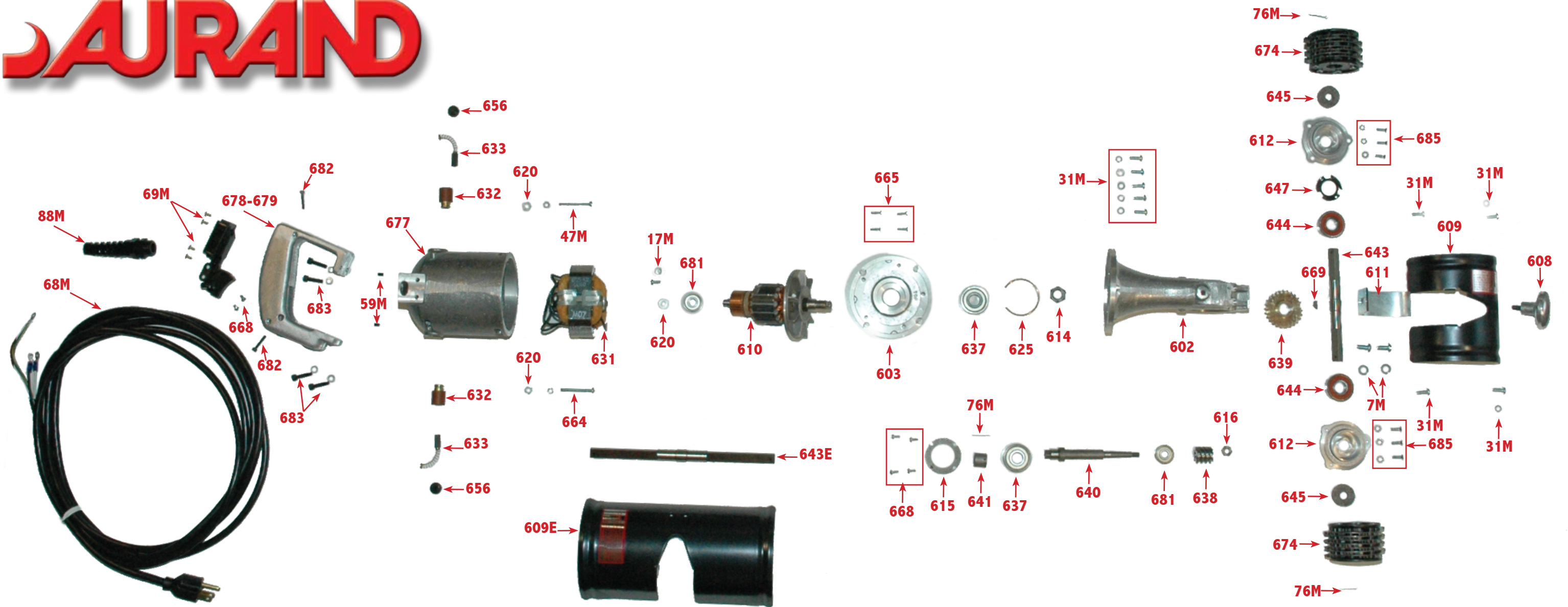

## PART NUMBERS

602 Gear Housing  
 603 Center Plate  
 608 Handle  
 609 Guard  
 609E Guard (K7-1E) Model  
 610 Armature (115V)  
 2610 Armature (230V)  
 611 Depth Shoe  
 612 Side Plate (2)  
 614 Armature Nut  
 615 BRG Retainer Plate  
 616 Worm Nut

620 Washer (3)  
 625 Bearing Ring  
 631 Field (115V)  
 2631 Field (230V)  
 632 Brush Holder (2)  
 633 Brush & Spring (2)  
 637 Bearing (2)  
 638 Worm  
 639 Worm Wheel  
 640 Worm Shaft  
 641 Coupling  
 643 Spindle

643E Spindle (K7-1E Model)  
 644 Bearing Spindle (2)  
 645 Cutter Bundle felt (2)  
 647 Spring Washer  
 656 Field Screw (2)  
 665 Center PL. Screw (4)  
 668 Ret. PL. Screw (6)  
 669 Woodruff Key  
 674 Cutter Bundle Set  
 674E Cutter Bundle Set (K7-1E Model)  
 677 Motor Housing  
 678 Handle

679 Handle  
 681 Bearing (2)  
 682 Cover Screw (2)  
 683 Handle Screw (4)  
 685 Side PL. Screw (6)  
 7M Depth Shoe Screw (2)  
 31M Screw & Washer (9)  
 59M Holder Set Screw (2)  
 69M Cable  
 76M Cotter Pin (3)  
 88M Cable Protector